

Isolation 20mm

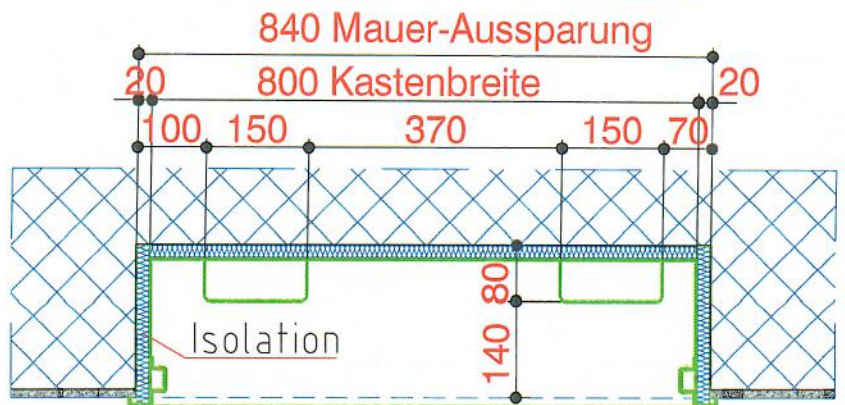

Grundriss Oberseite

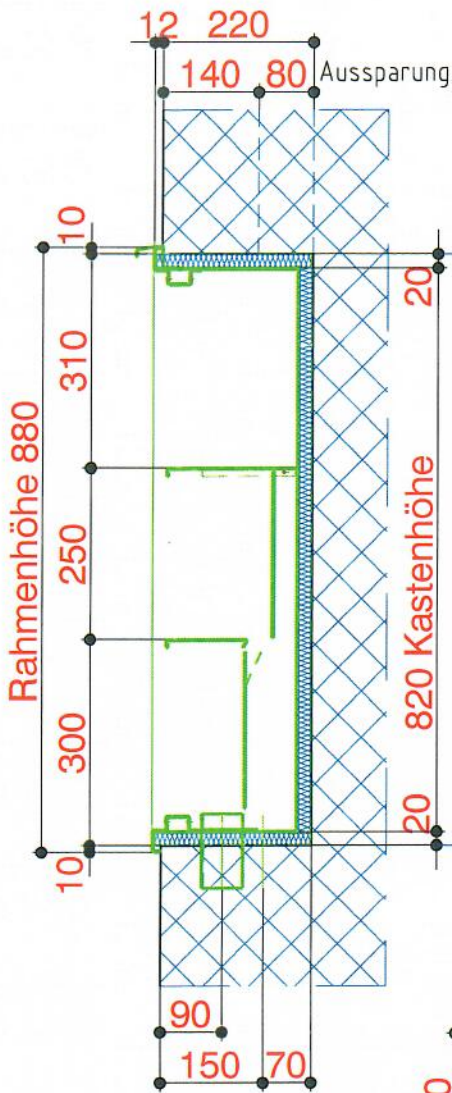

Vertikalschnitt

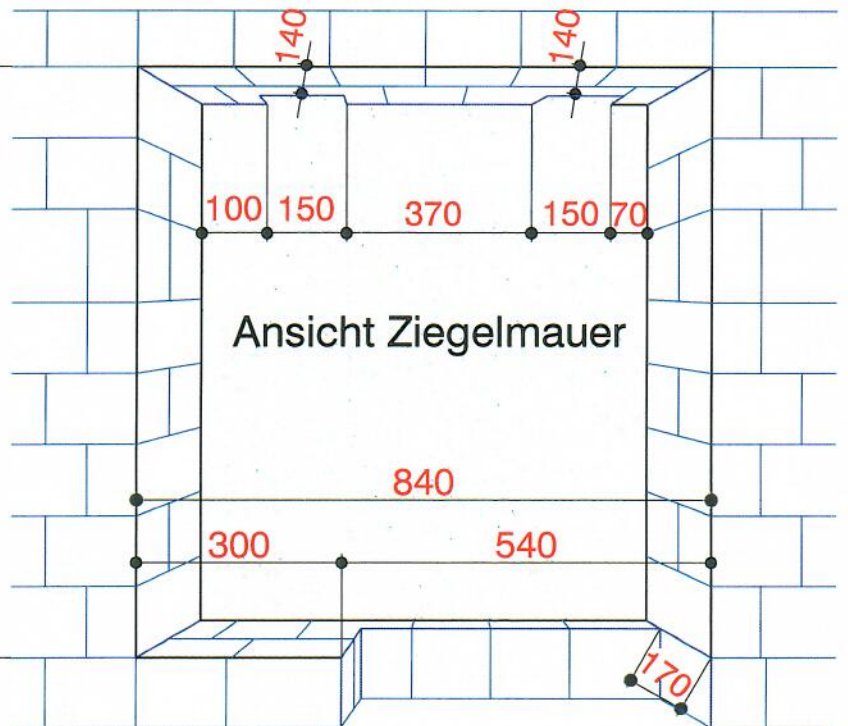

Ansicht Ziegelmauer

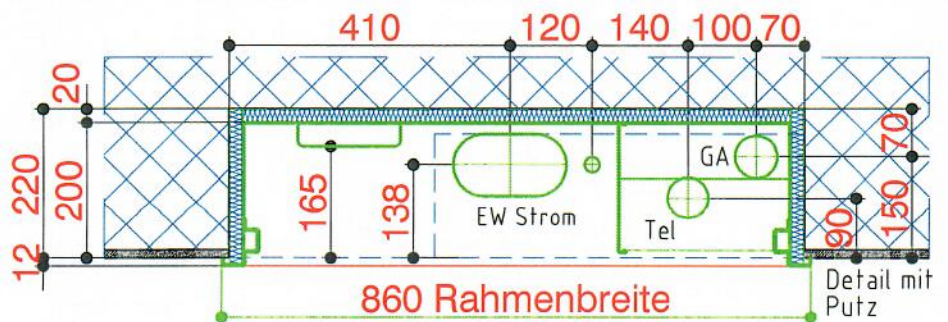

Grundriss Unterseite

Positionsmasse für Sichtbeton

|             |        |
|-------------|--------|
| EW - Strom  | ∅ 90mm |
| EW - Erdung | ∅ 30mm |
| CATV (GA)   | ∅ 60mm |
| TELEFON     | ∅ 60mm |

